

# Plug and Track (TCSV12) Quick Installation Guide

## Getting started

Before installing the TCSV12 unit, make sure you record the unit serial number (SN) and the check code (CK) from the label - this information is required for testing and activating the unit. **1** Many customers choose to take a photo of the label.

- Ensure the vehicle ignition is switched off and is parked in a safe area.
- Complete the installation with the vehicle parked outside with a clear view of the sky.
- Locate the position of the 16 pin diagnostic port for the vehicle. **2** The connector is usually under the dash, on either side of the foot-well or within the centre console. It may be necessary to remove a small section of trim or lift an access cover. If you're not sure where to find the diagnostic port on your vehicle, please check our [plug and track wiki](#) page or contact our Support team.
- Ensure that your vehicle's diagnostic port is the 16-pin port type. **3**

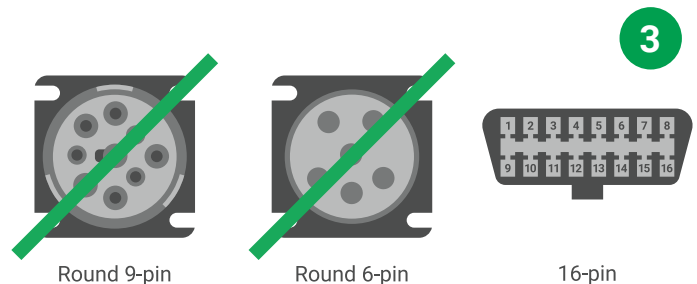
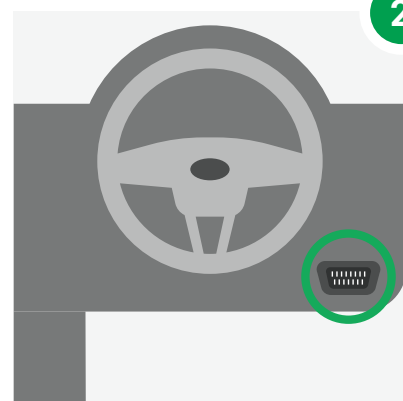

## Step 1: Installation

With the engine switched off, simply plug the unit into the 16 pin diagnostic port connector. **4** It may require firm pressure to mate with the connector. Leave the unit in position for approximately five minutes (to acquire GPS data) before proceeding to Step 2. Replace any trim after inserting the unit.

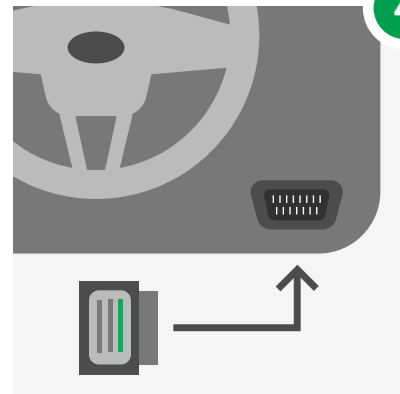

## Step 2: Pairing the device

Switch the ignition on (with engine running) and leave this on for approximately two minutes. Then switch off the engine and remove the ignition key.

Go to our online [Health Check Utility](#) site to check and verify operation of the TCSV12 tracker unit.

- Enter the unit serial number and check code from the label and select the Check Unit button. **5**
- Verify that the system has recorded the Ignition-On and then the Ignition-Off status changes that you performed in the list of events. **6**
- Check the vehicle position on the map.
- The installation is complete. **7**

**Quartix** Unit Health Check Utility v. 3.51

Please enter the serial number (5 or 6 digits after the hyphen) and six-digit check number or last four digits of phone

Serial Number

Six-digit check number or last four digits of phone

**Check Unit**

[Click here to login if you don't have the six-digit check number or last four digits of phone](#)

Login

Unit details:

UnitID 5002466

Serial 032017-371242

Protocol Fleet white label

Product TCSV12

Phone +447422

Version 614

Unit installed in vehicle: TCSV12 Rev A (UK/FR Fleet)

Unit installed in vehicle: TCSV12 Rev A (UK/FR Fleet)

Latest events (in local time) from UK/FR Fleet:

Date/Time	Event	Latitude	Longitude	DriverID	Sig	Stren	Sats	TiltX	TiltY	TiltZ	D
06/04/2017 11:43:20	Distance	52.24642	-0.24027	none	30	10	2	-25	-1	N	
06/04/2017 11:42:20	Distance	52.23988	-0.25534	none	28	10	-1	-20	1	N	
06/04/2017 11:41:20	Ignition-On	52.23800	-0.25083	none	0	0	-1	-21	1	N	
06/04/2017 11:39:01	Ignition-Off	52.23792	-0.25076	none	32	11	-1	-21	1	N	
06/04/2017 11:39:01	Distance	52.23792	-0.25076	none	32	11	-1	-21	1	N	
06/04/2017 11:38:03	Ignition-On	52.23793	-0.25076	none	0	0	-1	-21	1	N	
06/04/2017 11:37:33	Ignition-Off	52.23794	-0.25076	none	0	0	0	0	0	N	



## Support and Questions

If you have any questions during installation or if the Health Check Utility does not list the unit details, please contact our Support team through our [online form](#), by emailing [support@quartix.net](mailto:support@quartix.net) or calling our Helpdesk at **01686 806 663**.

## Compatibility and Safety Summary

The TCSV12 is designed for 12v cars and light commercial vehicles. The device cannot be plugged into 24v vehicles fitted with a Type B diagnostic connector. After installation, you should check that the device does not impede or affect the driver's operation or control of the vehicle in any way. If it does, then remove the product and contact Quartix in order for us to make alternative arrangements.

**The product must not be opened. It contains a Lithium Polymer battery and there are no user-serviceable items inside the product.**

Any repair or disposal of the product must be carried out by Quartix. If the unit experiences any operational problems, contact our Support team and they will arrange for the product to be replaced. The TCSV12 includes an internal 2A fuse. The vehicle diagnostic port also includes a fused 12v power feed. The TCSV12 has been independently tested and meets all relevant CE (EMC) and VCA e-mark compliance. The product is designed to operate from -30°C to +80°C. The internal Lithium Polymer battery will only charge between 0°C to +40°C.